

Flange Valve Cut Sheet

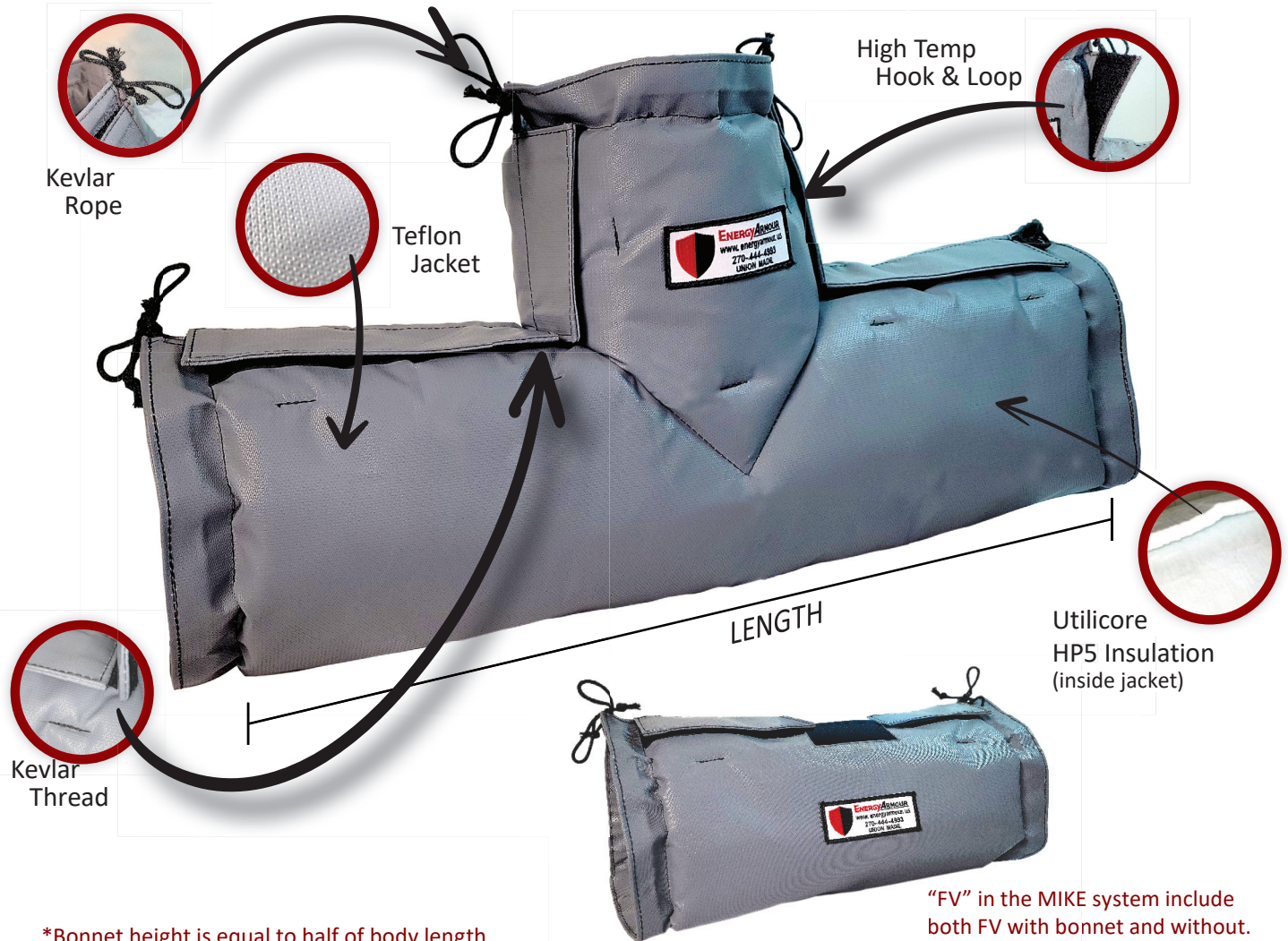

www.EnergyArmour.us

Heat Conservation • Personnel Protection • Acoustical Reduction



*Bonnet height is equal to half of body length.

"FV" in the MIKE system include both FV with bonnet and without.

PIPE SIZE	0.50"	0.75"	1.00"	1.25"	1.50"	2.00"	2.50"	3.00"	3.50"	4.00"	4.50"	5.00"	6.00"
LENGTH	18"	18"	20"	20"	20"	22"	22"	22"	24"	24"	28"	28"	30"

PIPE SIZE	7.00"	8.00"	9.00"	10.00"	11.00"	12.00"	14.00"	16.00"	18.00"	20.00"	4.50"	24.00"
LENGTH	30"	30"	32"	32"	34"	34"	36"	38"	40"	42"	44"	48"

*All blanket diameters are based on 150# & 300# flange sizes.

Specifications for insulation thicknesses up through 1 ½" will utilize 1" thick blankets pricing & construction. Specifications for Insulation thicknesses 2" through 2 ½" will utilize 2" thick blankets pricing & construction.

Pricing does not reflect any hole penetrations. Call for adjusted discount for hole allowance.



For more information,
CALL: 270.444.4993

Or you can email us at:
info@energyarmour.us